

Dimension Sheet for Spark Quenching Unit Type 070.000.6

(M.0700006.GB)

Application

Reduces spark production on the switching contacts occurring during VDC inductive load switching.

- Voltage limitation according to VDE0580 2000-07, Item 4.6.
- Reduction of EMC-disturbance by voltage rise limitation, suppression of switching sparks.
- Reduction of brake engagement times by a factor of 2-4 compared to freewheel diodes.

Function

The spark quenching unit will absorb voltage peaks resulting from inductive load switching, which can cause damage to insulation and contacts. It limits these to 70V and reduces the contact load. Switching products with a contact opening distance of > 3 mm are suitable for this purpose.

Electrical Connection (Terminal)

- 1 (+) Input voltage
- 2 (-) Input voltage
- 3 (-) Coil
- 4 (+) Coil
- 5 Free nc terminal
- 6 Free nc terminal

Technical Data

Input voltage	max. 300 VDC, max. 615 V _{peak} (rectified voltage 400 VAC, 50/60 Hz)
Switch-off energy	max. 9J/2 ms
Power dissipation	max. 0.1 Watt
Max. voltage nc terminals	250 V
Protection	IP65 / IP20 terminals
Ambient temperature	-25 °C up to +85 °C
Storage temperature	-25 °C up to +105 °C
Max. conductor connection diameter	2.5 mm ² / AWG 26-12
Max. terminal tightening torque	0.5 Nm

Accessories:

- Mounting bracket set for 35 mm rail acc. to EN50022:
Article No. 1803201



Dimensions (mm)

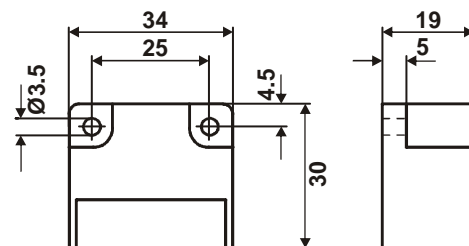

Order Example

To be stated on order:	Size	Type
Order number	1	070.000.6